



Installation Instructions

615104

2012-15 CHEVY CAMARO
3.6L Engine

NOT LEGAL FOR SALE OR USE ON ANY POLLUTION-CONTROLLED MOTOR VEHICLE IN CALIFORNIA OR IN STATES THAT HAVE ADOPTED CALIFORNIA EMISSION PROCEDURES.

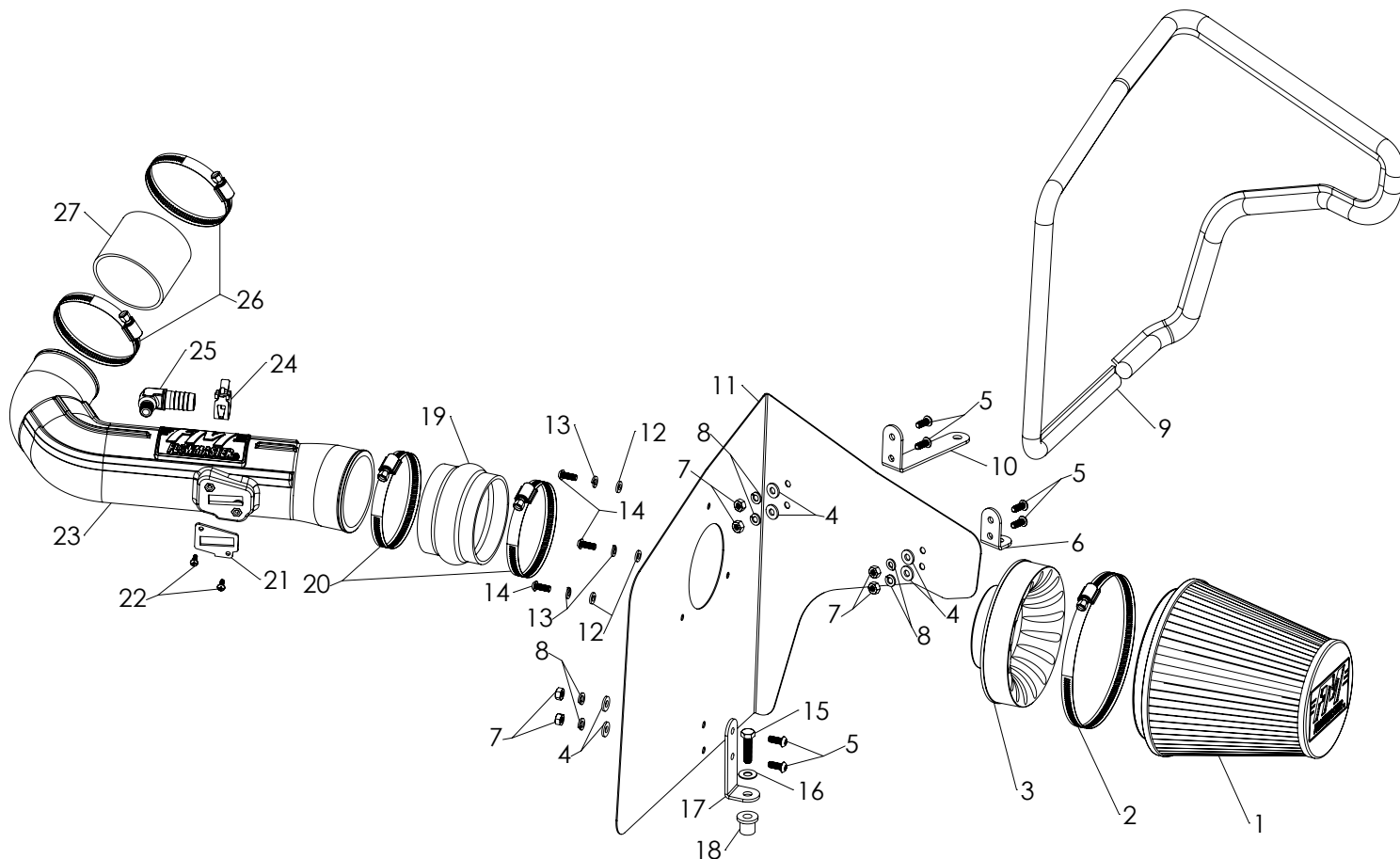

ITEM NO.	PART NUMBER	DESCRIPTION	QTY.
1		AIR FILTER, 7-1/2" x 6" DIA	1
2	AF1002	SCREW CLAMP, #104 (4-1/8" - 7")	1
3	AF6001	ADAPTER, AIR FILTER 3-1/2" x 6"	1
4	HW320	FLAT WASHER, 1/4"	6
5	HW245	SCREW, 1/4"-20 x 5/8"	6
6	AF5001	BRACKET 1, 10-15, CAMARO, 6.2L	1
7	HW115	NUT, 1/4"-20	6
8	HW322	LOCK WASHER, 1/4"	6
9	49000061	GASKET, HEAT SHIELD	78"
10	AF5003	BRACKET 3, 10-15, CAMARO, 6.2L	1
11	AF3012	11-15 CAMARO BASE V6 3.6L INTAKE AIRBOX	1
12	HW319	FLAT WASHER, M6	3
13	HW318	LOCK WASHER, M6	3
14	HW244	SCREW, M6 x 1.0 x 16MM	3

ITEM NO.	PART NUMBER	DESCRIPTION	QTY.
15	HW246	BOLT, 5/16"-18 x 1-1/4"	1
16	HW321	FLAT WASHER, 5/16"	1
17	AF5002	BRACKET 2, 10-15, CAMARO, 6.2L	1
18	HW122	WELL NUT, RUBBER, 5/16"-18	1
19	AF4019	COUPLER, FLEX 3-1/2" I.D. x 2-1/2" L	1
20	MC350H	SCREW CLAMP, #56 (3-1/16" - 4")	2
21	GA139	GASKET, MAF SENSOR	1
22	HW248	SCREW, M4 x 0.7 x 12MM	2
23	AF2012	INTAKE TUBE, 10-15 CAMARO BASE V6 3.6L	1
24	MC005P	PINCH CLAMP, 3/4" HOSE	1
25	AF4014	ELBOW, 90°, 3/4" BARB TO 1/4" NPT MALE	1
26	MC314H	SCREW CLAMP, #52 (2-13/16" - 3-3/4")	2
27	AF4030	COUPLER, STRAIGHT 3" I.D. x 2-1/2" L	1

REVIEW INSTRUCTIONS AND VERIFY KIT CONTENTS:

1. Please read and understand these instructions before installing your Flowmaster cold air intake kit.



2. Use the parts drawing and list (front page) to verify your kit's contents.

In the unlikely event that any parts are missing, please contact FLOWMASTER Technical Support (see number below) for replacements.

To simplify assembly and avoid cross-threading fasteners, identify and separate the ¼-20 screws and nuts (items 5 and 7), and the M6 screws (14) (no nuts).

REMOVE FACTORY AIR INTAKE SYSTEM:

NOTES

- We highly recommend that you retain all factory air intake system parts.
- Please refer to vehicle manufacturer's recommendations regarding removal of factory components.
- Disconnecting the negative battery cable erases pre-programmed electronic memories. Write down all memory settings before disconnecting the negative battery cable. Some radios will require an anti-theft code to be entered after the battery is reconnected. The anti-theft code is typically supplied with your owner's manual. In the event your vehicle's anti-theft code cannot be recovered, contact an authorized dealership to obtain your vehicle's anti-theft code.

- 3. Turn off the vehicle's ignition and disconnect the negative battery cable.**



4. Remove the oil fill cap and temporarily protect the open fill neck with a clean paper towel.

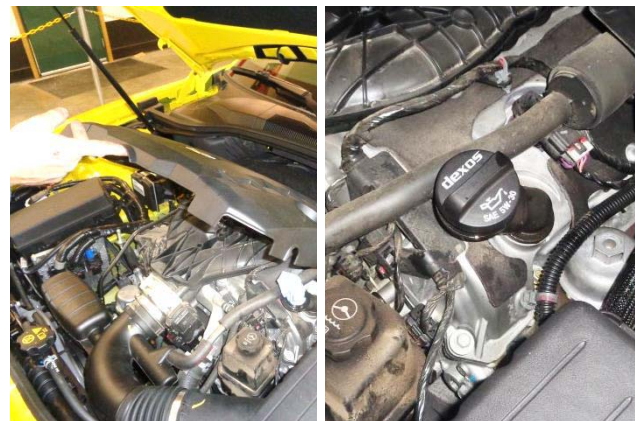

5. Remove the engine heat shield, then remove the paper towel from the fill neck and reinstall the fill cap.

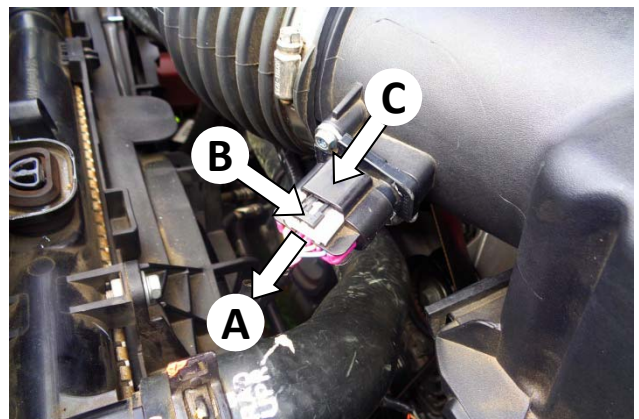

6. Carefully remove the mass airflow (MAF) sensor's electrical connector as follows:
 - A. Pull the locking tab out until it stops; then
 - B. depress the latch, while
 - C. pulling the connector straight off the sensor.

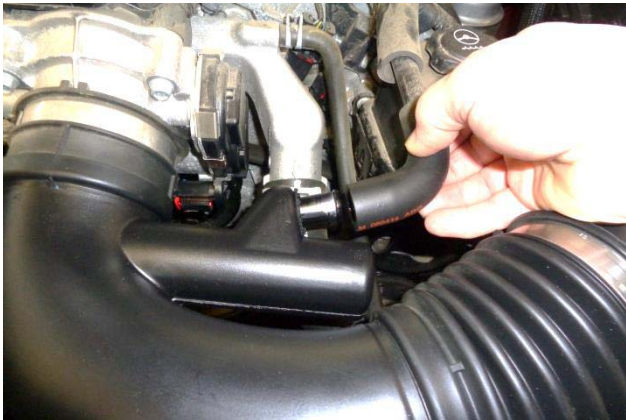

7. Disconnect the positive crankcase ventilation (PCV) tube from its fitting on the intake tube.



8. Loosen the hose clamp that secures the intake tube to the throttle body.

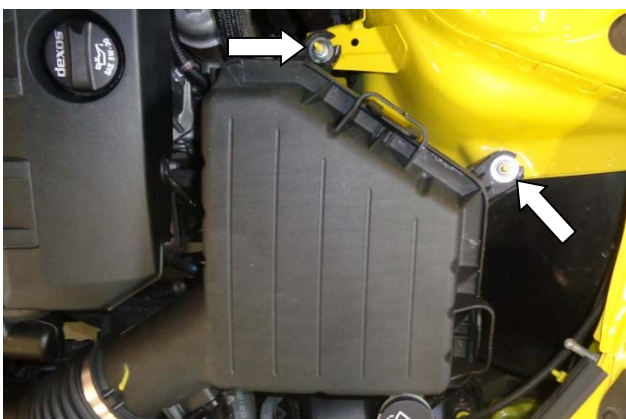

9. Remove the 2 airbox nuts. Firmly lift the airbox straight up to release it from its rubber grommet, then carefully remove the airbox and intake tube from the vehicle. **Retain nuts for reinstallation at Step 16.**



10. Remove rubber grommet from vehicle frame.



11. Remove the MAF sensor from the intake tube, then remove the factory gasket from the sensor.
CAUTION: The sensor is delicate! Handle with care, and store in a safe location until reinstallation.

ASSEMBLE AND INSTALL YOUR FLOWMASTER COLD AIR INTAKE SYSTEM:

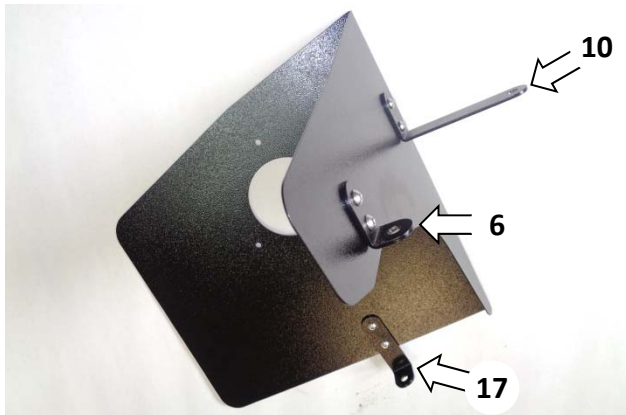

12. Attach brackets (6), (10) and (17) to airbox (11) at the locations shown, using 1/4-20 screws (5) (against the brackets), and flat washers (4), lock washers (8) and nuts (7) (against the airbox).



13. Attach rubber trim seal (9) to airbox. Starting next to bracket (17), press trim seal fully onto edge of airbox, slowly working around the airbox. When you return to the other side of bracket (17), trim the seal to fit using metal cutting shears.

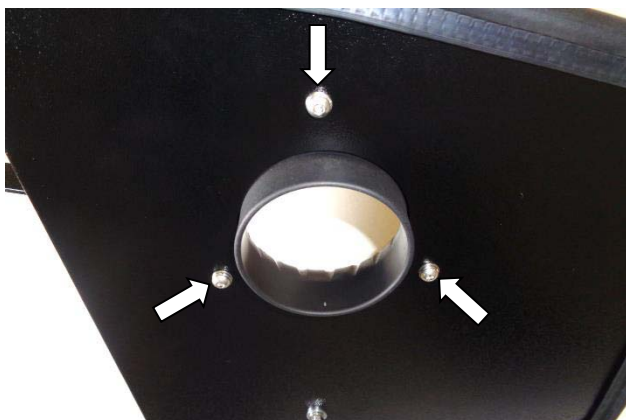

14. Attach air filter adapter (3) to airbox using M6 screws (14), lock washers (13) and flat washers (12).

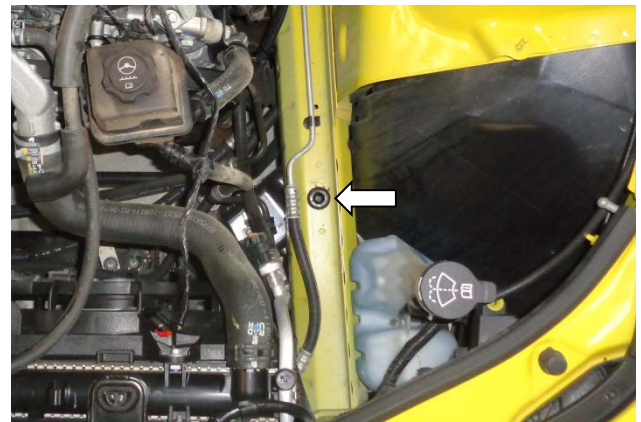

15. Place rubber well nut (18) in the mount hole that the grommet was removed from in Step 10.

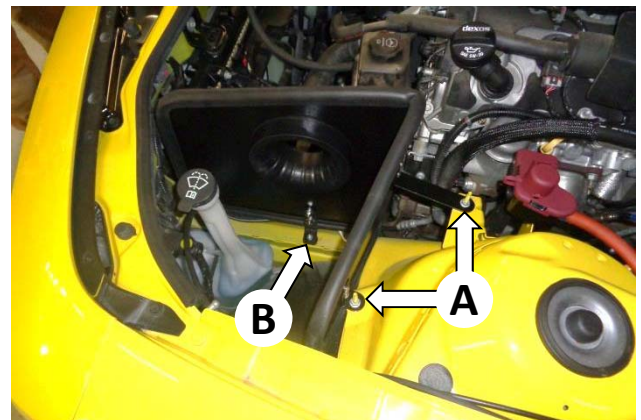

16. Install the assembled airbox:
- A. Slip the 2 upper brackets over the studs, and hand-start the nuts removed at Step 9.
 - B. At the lower bracket, install the 5/16-18 bolt (15) and flat washer (16) in the well nut. Tighten all three fasteners.



17. Apply 2 wraps of nylon thread tape to threads of PCV elbow (25), and install elbow into intake tube (23).



18. Install MAF sensor gasket (21) onto the sensor, ensuring correct orientation. Then install sensor in intake tube, using M4 screws (22).



19. Install 2 hose clamps (20) on flex (or humped) coupler (19), then install coupler on intake end of intake tube. Orient clamp screws upward to allow tightening after installation on vehicle.

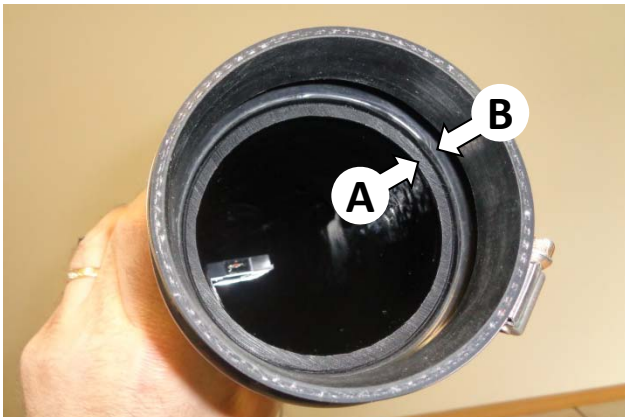

20. To allow proper flexing of the flex coupler during engine torqueing, verify that the end of the intake tube (A) sits behind the coupler's transition lip (B).



21. Install 2 hose clamps (26) on straight coupler (27), then install coupler on discharge end of intake tube. Orient clamp screws upward to allow tightening after installation on vehicle.



22. Install assembled intake tube in vehicle and tighten all hose clamps.



23. Install clamp (2) on air filter (1), install filter on filter adapter and tighten clamp.

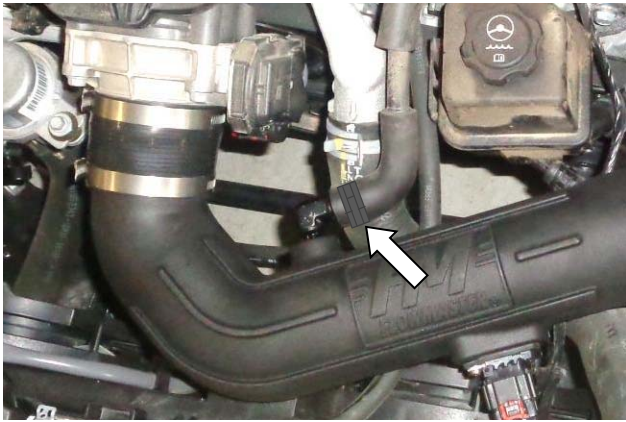

24. Install pinch clamp (24) on PCV hose, then install hose on elbow, checking for secure installation.



25. Reinstall the connector on the MAF sensor and close the locking tab, checking that the connector is secure.



26. Remove the oil fill cap and temporarily protect the open fill neck with a clean paper towel. Reinstall the engine heat shield, remove the paper towel from the fill neck, and reinstall the fill cap.

Congratulations, the installation of your FLOWMASTER cold air intake kit is now complete!