



Installation Instructions

615173

2014-16 FORD FIESTA ST 1.6L TURBO ENGINE

NOT LEGAL FOR SALE OR USE ON ANY POLLUTION-CONTROLLED MOTOR VEHICLE IN CALIFORNIA OR IN STATES THAT HAVE ADOPTED CALIFORNIA EMISSION PROCEDURES.

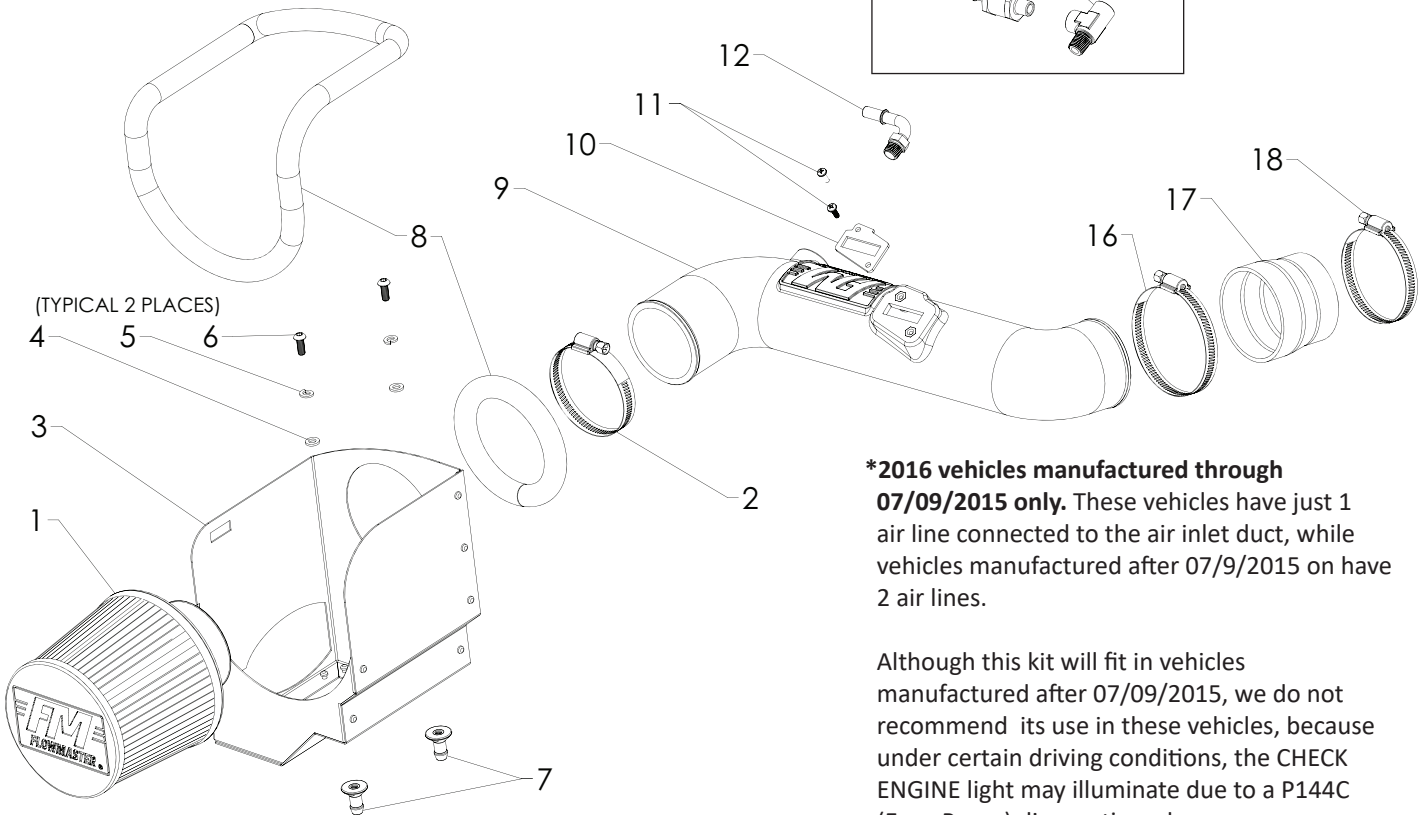
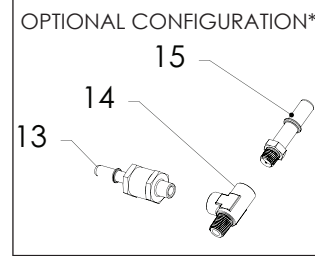

***2016 vehicles manufactured through 07/09/2015 only.** These vehicles have just 1 air line connected to the air inlet duct, while vehicles manufactured after 07/9/2015 on have 2 air lines.

Although this kit will fit in vehicles manufactured after 07/09/2015, we do not recommend its use in these vehicles, because under certain driving conditions, the CHECK ENGINE light may illuminate due to a P144C (Evap Purge) diagnostic code.

ITEM NO.	PART NUMBER	DESCRIPTION	QTY.
1	AF1004	AIR FILTER, 6-7/8" x 2-3/4" DIA	1
2		CLAMP, SCREW, #44 (2-1/4" - 3-1/4")	1
3	AF3054	HEAT SHIELD	1
4	HW319	FLAT WASHER, M6	2
5	HW318	LOCK WASHER, M6	2
6	HW244	SCREW, M6 x 1.0 x 16MM	2
7	AF7001	BARBED PIN, M6 x 1.0	2
8	49000061	GASKET, HEAT SHIELD	60"
9	AF2054	INTAKE TUBE	1

ITEM NO.	PART NUMBER	DESCRIPTION	QTY.
10	GA139	GASKET, MAF SENSOR	1
11	HW248	SCREW, M4 x 0.7 x 12MM	2
12	AF4018	ELBOW, 90°, 3/8" QUICK CONN TO 1/4" NPT MALE	1
13	AF4080	CHECK VALVE, 3/8" QUICK CONN TO 1/4" NPT MALE	1
14	AF4079	PIPE TEE, 1/4" NPT MALE (1 RUN) TO 1/4" NPT FEMALE (2)	1
15	AF4081	FITTING, STRAIGHT, W/METERED ORIFICE, 1/2" QUICK CONN TO 1/4" NPT MALE	1
16	MC314H	CLAMP, SCREW, #52 (2-13/16" - 3-3/4")	1
17	AF4063	COUPLER, REDUCING, 3" I.D. - 2-3/4" I.D. x 2-1/2" L	1
18	MC250H	CLAMP, SCREW, #44 (2-1/4" - 3-1/4")	1

REVIEW THESE INSTRUCTIONS AND VERIFY THE KIT CONTENTS

1. Take a moment to read and understand these instructions before installing your Flowmaster performance air intake system.



2. Use the parts drawing and list (front page) to verify your kit's contents.

In the unlikely event that any parts are missing, contact Flowmaster Technical Support for replacements.

REMOVE THE FACTORY AIR INTAKE SYSTEM

NOTES

- We highly recommend that you retain all factory air intake system parts.
 - Refer to your vehicle manufacturer's recommendations regarding removal of factory components.
 - Disconnecting the negative battery cable erases pre-programmed electronic memories. Write down all memory settings before disconnecting the negative battery cable. Some radios will require an anti-theft code to be entered after the battery is reconnected. The anti-theft code is typically supplied with your owner's manual. In the event your vehicle's anti-theft code cannot be recovered, contact an authorized dealership to obtain it.
3. Turn off the vehicle's ignition and disconnect the negative battery cable. **Failure to disconnect the battery may cause the CHECK ENGINE light to illuminate after the air intake kit is installed.**



4. Remove the engine appearance cover from the vehicle by lifting it up sharply at its corners to separate it from its 4 friction mount pins.



5. Disconnect the mass airflow (MAF) sensor plug by pulling the red locking tab away from the sensor, then squeezing the flat sides of the plug and pulling it straight off the sensor.

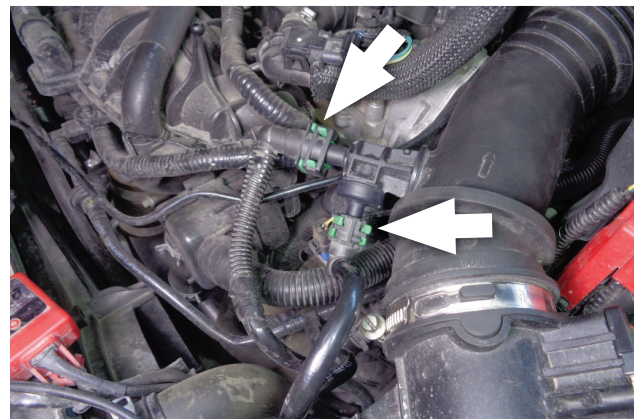

6. **NOTE: Vehicles manufactured on or after 07/10/2015 have 2 air lines connected to the inlet air duct (shown). Vehicles manufactured on or before 07/09/2015 have 1 air line.** (See footnote* on page 1.) Disconnect the air line(s) from the inlet air duct by releasing the green locking tab(s), then pulling the line(s) off the fitting.

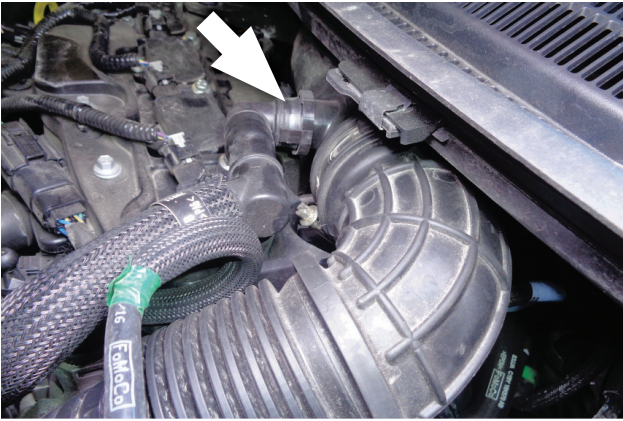

7. Disconnect the PCV line from the turbocharger inlet duct by squeezing the locking ring, then pulling the line off the fitting.



10. Separate the inlet air duct from the airbox and turbo inlet, and remove it from the vehicle.

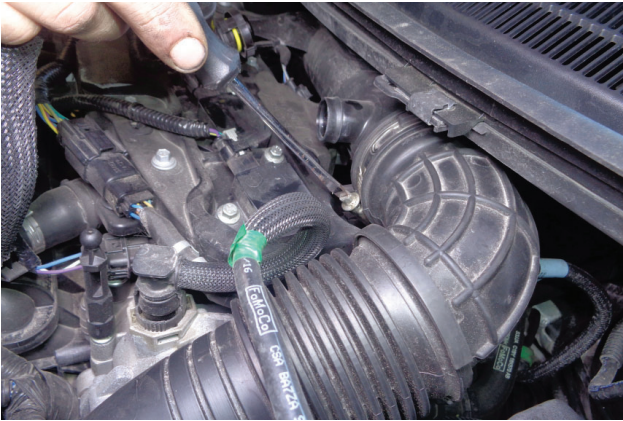

8. Loosen the screw clamp that secures the inlet air duct to the turbo inlet.

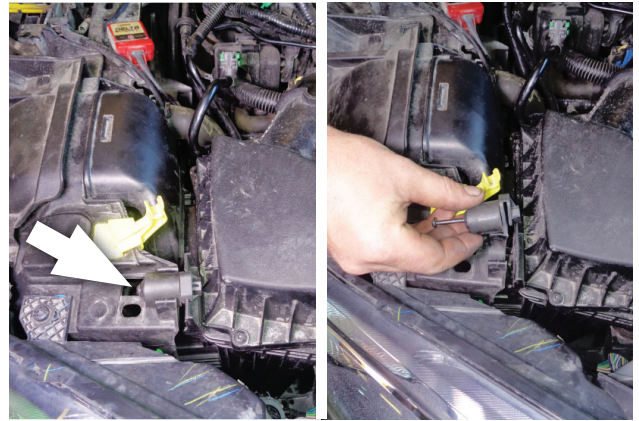

11. At the front corner of the airbox, remove the screw from the rubber mount plug, remove the screw and plug from the vehicle, and set them aside to be used later.

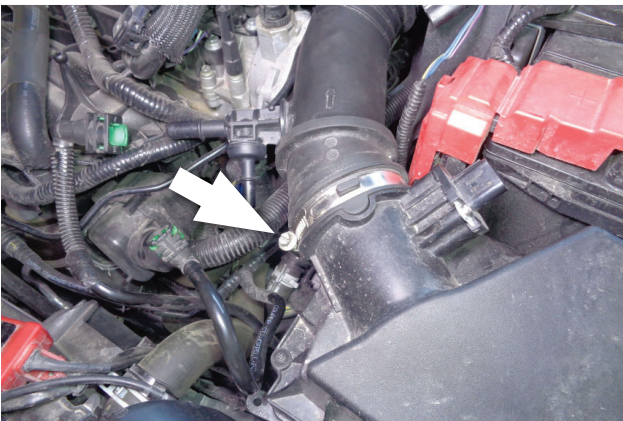

9. Loosen the screw clamp that secures the airbox to the inlet air duct.

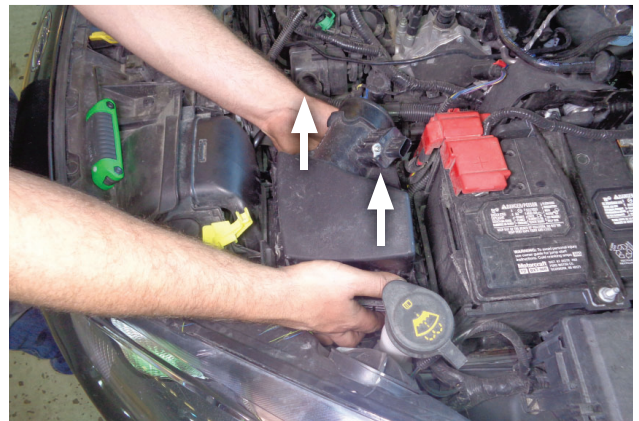

12. Lift the airbox up sharply about 1–2 inches—just enough to release it from its 2 mount grommets.

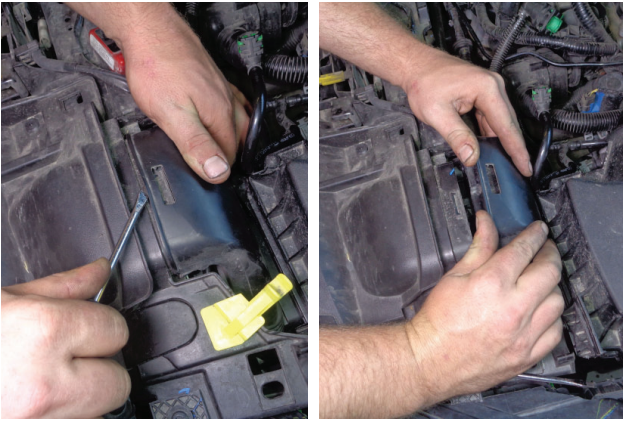

13. Separate the ram air duct from the radiator support.



14. Remove the airbox and ram air duct from the vehicle.

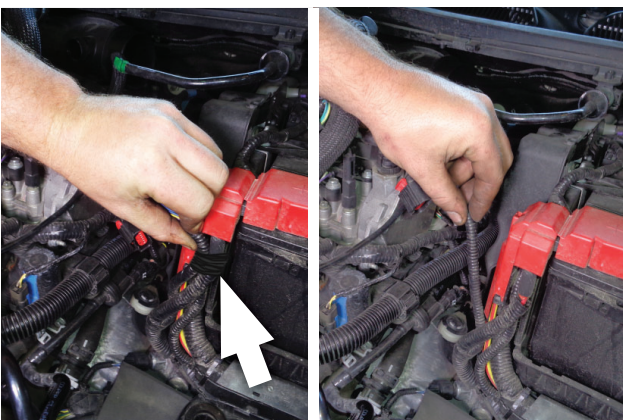

15. Remove the cable tie or electrical tape that secures the MAF sensor lead to the main electrical harness (just below the positive battery terminal).

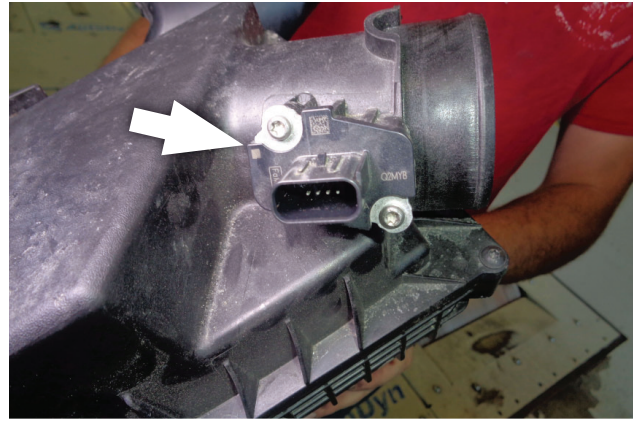

16. Remove the MAF sensor from the airbox, then remove the gasket from the MAF sensor.

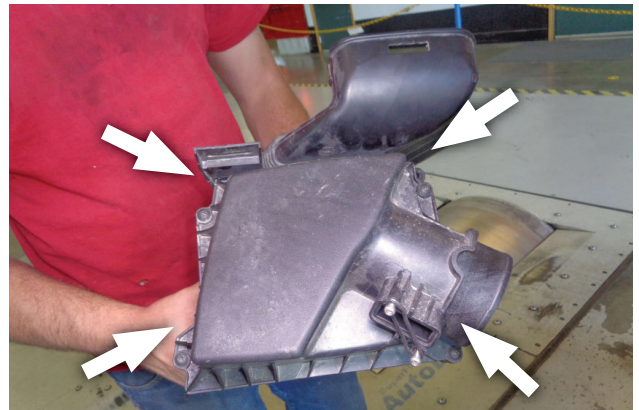

17. Remove the cover (4 corner screws) and filter element from the airbox.



18. Remove the ram air duct from the airbox.

ASSEMBLE AND INSTALL YOUR FLOWMASTER PERFORMANCE AIR INTAKE SYSTEM

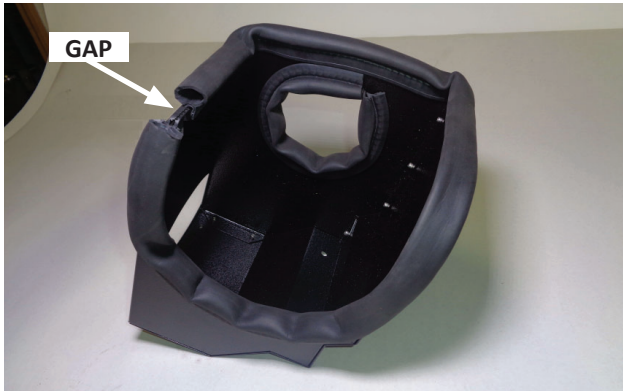

19. Attach the gasket (8) to both the outer edge and the air tube opening of the heat shield (3). Leave a gap over the small rectangular hole for the rubber mount plug. Start on one side of the gap, firmly press the gasket onto the edge, gradually working all the way around. When you return to the other side of the gap, use metal-cutting shears to trim the gasket to fit.



20. Assemble the 2 barbed pins (7) to the heat shield, using the M6 screws (6), lock washers (5) and flat washers (4).



21. Snap the ram air duct into the heat shield. (The fit will be slightly loose.)

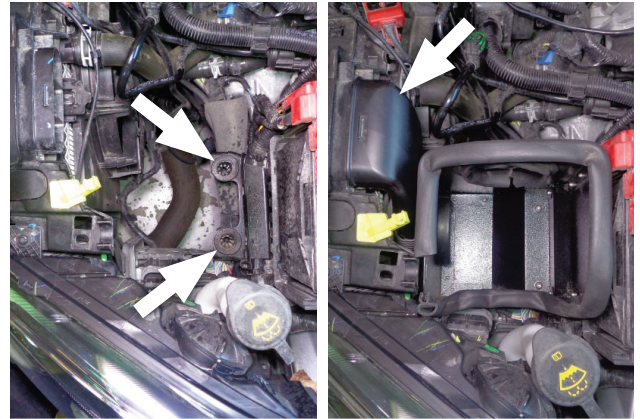

22. Push the heat shield's barbed pins into the mount grommets. Then snap the ram air duct into its opening on the radiator support.



23. Push the rubber mount plug over the edge of the heat shield and into its saddle the radiator support, then secure it with its screw.

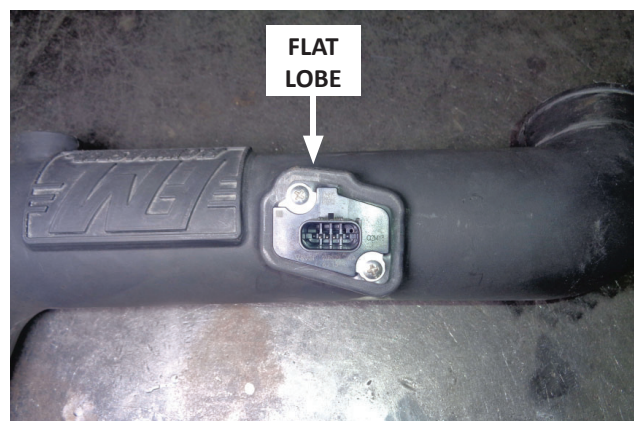

24. Install the MAF sensor gasket (10) on the sensor, then install the sensor in the intake tube (9). **NOTE: Ensure the correct orientation of the gasket, sensor and mount pad (note the flat lobe).** Secure the sensor to the tube with the M4 screws (11).



25. Slip the #52 screw clamp (16) onto the large end of the coupler (17), and install the coupler on the discharge end of the intake tube. Then slip the #44 screw clamp (18) on the other end of the coupler. Do not tighten the clamps at this time.



26. **VEHICLES WITH TWO AIR LINES (see footnote* on page 1):** Apply 2 wraps of nylon thread tape to the tee fitting (14), metered fitting (15), and check valve (13). Then install them in the intake tube, aligning the check valve with the tube's mold seam as shown.



27. **VEHICLES WITH ONE AIR LINE:** Apply 2 wraps of nylon thread tape to the QC elbow (12). Then install the elbow in the intake tube, aligning it with the tube's mold seam as shown.

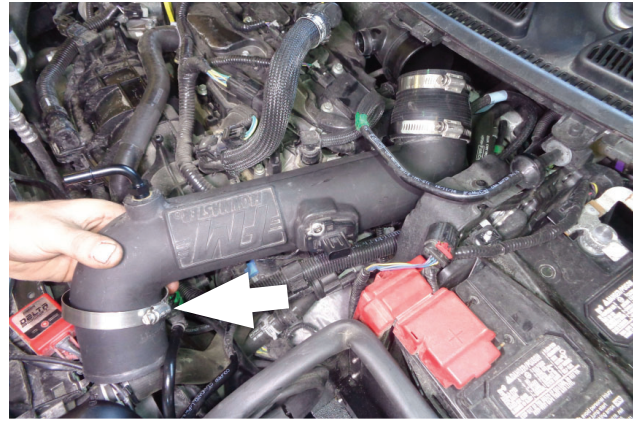

28. Slip the filter clamp (2) over the filter-end of the intake tube, then start to install the tube in the vehicle by slipping the coupler over the turbo inlet.

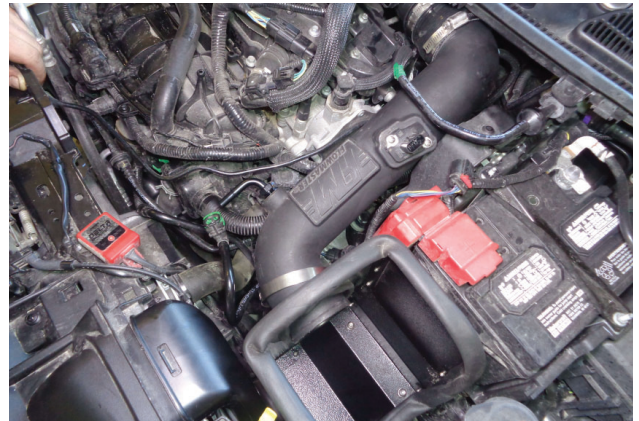

29. Insert the front end of the intake tube into the heat shield.



30. Push the coupler flush against the raised lip on the turbo inlet, then tighten the turbo inlet clamp only.

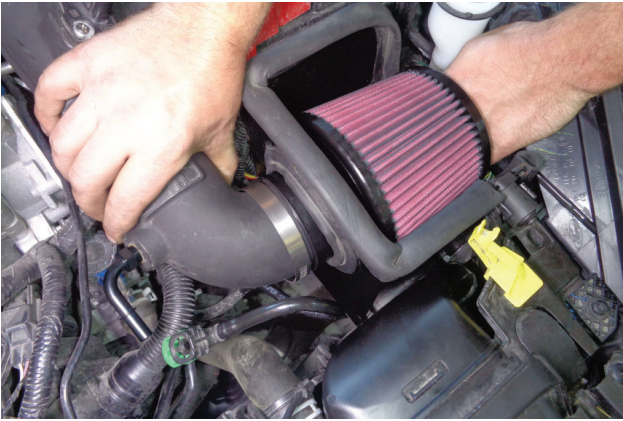

31. Carefully push the air filter (1) through the heat shield gasket and onto the intake tube.



32. Ensure that there is a minimum ½" overlap between the intake tube and the filter flange, then tighten the screw clamp. NOTE: When tightened, a small margin of the clamp may sit under the gasket.



33. Tighten the coupler clamp at the intake tube.



34. Reconnect the PCV tube to its port on the turbo inlet, then verify that the connection is secure.



35. Connect the MAF sensor plug to the sensor, close the latch, and check the connection for security.

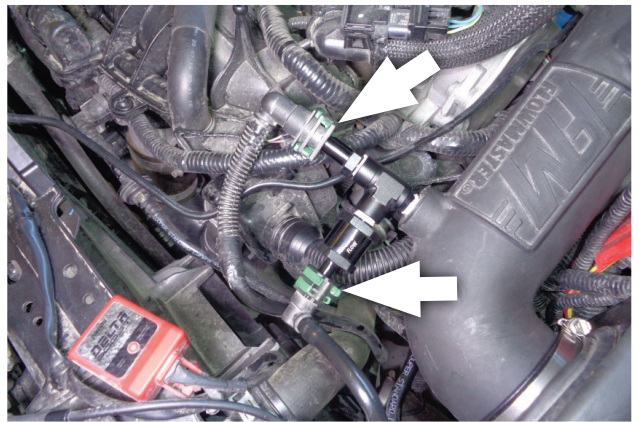

36. **VEHICLES WITH TWO AIR LINES (see footnote* on page 1):** Connect the 2 air lines to the QC fitting and check valve, close their green locking tabs, and check the security of the connections.

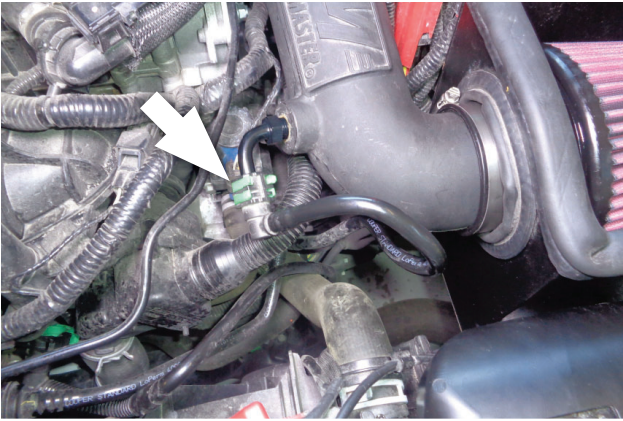

37. VEHICLES WITH ONE AIR LINE: Connect the air line to the QC elbow, close the green locking tab, and check the security of the connection.



38. Reinstall the engine appearance cover on its 4 friction mounts. If the corner of the cover touches the intake tube, adjust the tube's alignment.



Congratulations, the installation of your FLOWMASTER performance air intake kit is now complete!

FILTER MAINTENANCE

We recommend that you clean and oil your air filter at 25,000 mile intervals using **Flowmaster's Filter Refresh Kit (PN 615001)**. See our website or your Flowmaster distributor for details.

IMPORTANT: RETAIN THESE INSTRUCTIONS FOR FUTURE REFERENCE

