



Installation Instructions
615194
2017-19 FORD F-250/F-350 TRUCKS
6.2L ENGINE

NOT LEGAL FOR SALE OR USE ON ANY POLLUTION-CONTROLLED MOTOR VEHICLE IN CALIFORNIA OR IN STATES THAT HAVE ADOPTED CALIFORNIA EMISSION PROCEDURES.

OVERVIEW:

ITM #	PART #	DESCRIPTION	QTY.
1	AF1001	8 $\frac{5}{8}$ " x 6" Dia Air Filter	1
2		#104 (4 $\frac{7}{8}$ " - 7") Screw Clamp	1
3	AF2085	Molded Intake Tube	1
4	AF3087	Airbox	1
5	AF6003	4 $\frac{1}{2}$ " x 6" Air Filter Adapter	1
6	AF5097	Bracket 1	1
7	AF5098	Bracket 2	1
8	AF4070	4 $\frac{1}{2}$ " ID x 2 $\frac{1}{2}$ " L Hump Coupler	1
9	AF4062	4"x3 $\frac{1}{2}$ "x3" Straight Coupler	1
10	MC350H	#56 3 $\frac{1}{16}$ " - 4" Screw Clamp	1
11	MC400H	#64 3 $\frac{1}{16}$ " - 4 $\frac{1}{2}$ " Screw Clamp	1
12	MC450H	#72 3" - 5" Screw Clamp	2
13	49000061	Heat Shield Gasket	1
14	49000065-12	$\frac{3}{8}$ " ID Hose	1
15	49000065-24	$\frac{3}{8}$ " ID Hose	1

ITM #	PART #	DESCRIPTION	QTY.
16	49000068	$\frac{5}{8}$ " ID Hose	1
N/A	PK998	Hardware Package includes:	1
17	AF4032	$\frac{5}{8}$ " Barb- $\frac{1}{4}$ " Male Straight Fitting	1
18	AF4033	$\frac{1}{4}$ " NPT Plug	1
19	AF4040	$\frac{3}{8}$ " Barb- $\frac{1}{4}$ " Male Straight Fitting	2
20	MC002P	$\frac{3}{8}$ " Hose Pinch Clamp	4
21	MC004P	$\frac{5}{8}$ " Hose Pinch Clamp	2
22	AF7001	M6 x 1.0 Barbed Pin	2
23	HW244	M6 x 1.0 x 16MM Screw	5
24	HW318	M6 Lock Washer	5
25	HW319	M6 Flat Washer	5
26	HW245	$\frac{1}{4}$ "-20 x $\frac{5}{8}$ " Screw	3
27	HW320	$\frac{1}{4}$ " Flat Washer	3
28	HW322	$\frac{1}{4}$ " Lock Washer	3
29	HW115	$\frac{1}{4}$ "-20 Nut	3

NOTE: Please inventory all parts before starting the installation process (compare your parts to diagram on page 2) and call our tech line to report any missing parts. This will help avoid potentially stranding your vehicle until any missing replacement parts arrive.



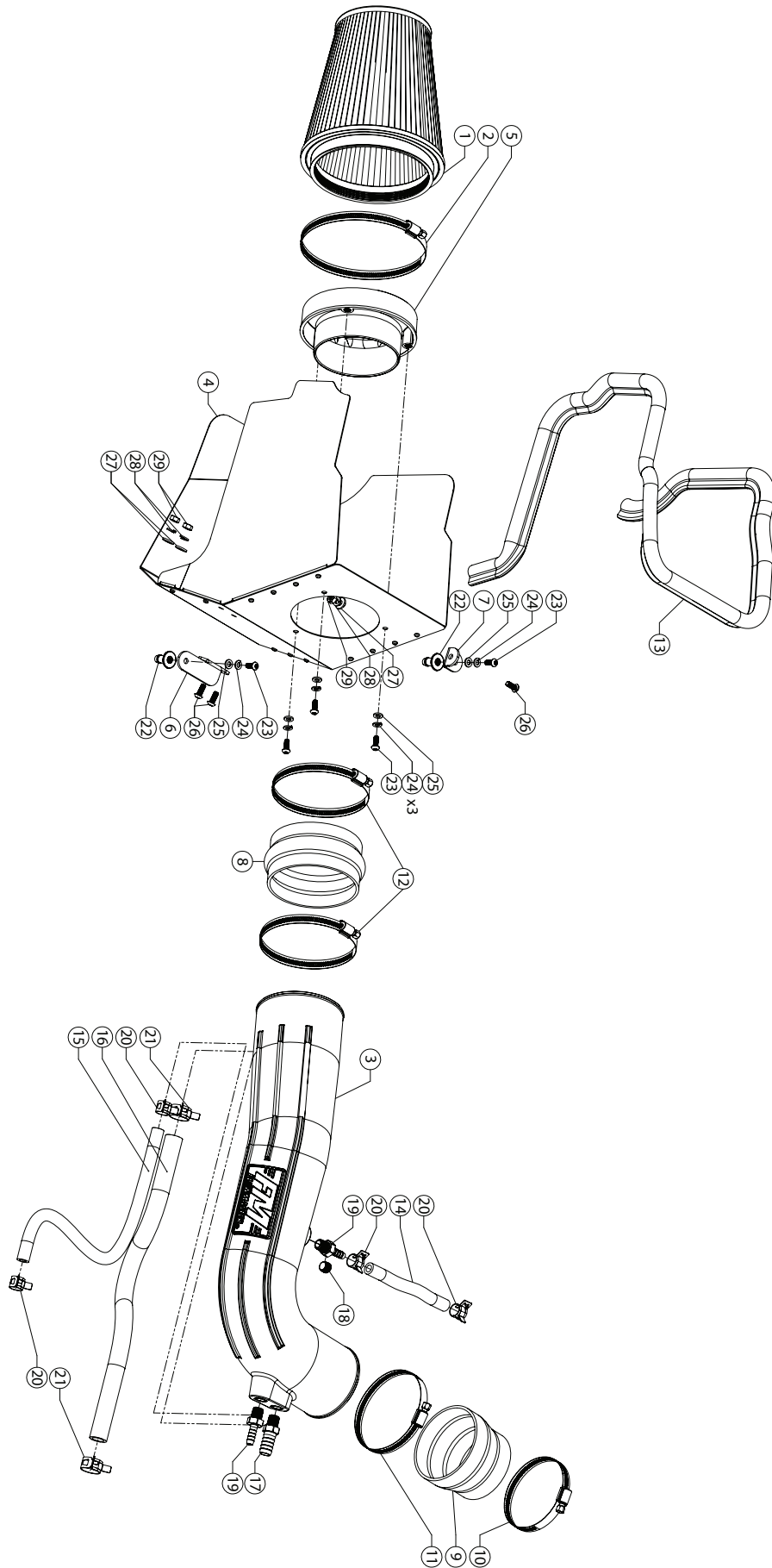

PREPARE VEHICLE FOR INSTALLATION:

1. Take a moment to read and understand these instructions before installing your Flowmaster performance intake system.

WARNING:

Avoid serious burns! Allow vehicle time to cool completely before handling any stock components.



2. Open hood, then disconnect vacuum line from drivers side of intake tube.



3. Disconnect PCV from intake tube.



NOTE: Not all vehicles have this particular vacuum line. If yours doesn't, skip this step.

4. Disconnect vacuum line from back of intake tube.

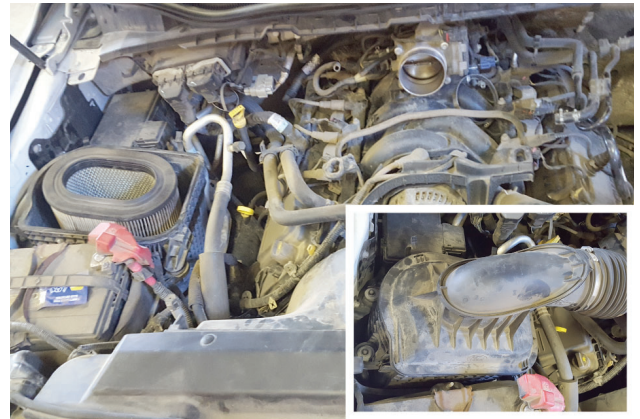

5. Detach clasps (x4) securing filter then remove intake tube assembly from vehicle.

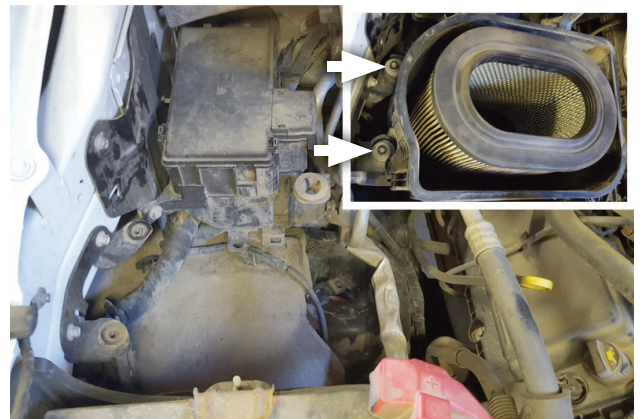

6. Remove bolts (x2) then remove factory airbox from vehicle. Retain bolts for later use.

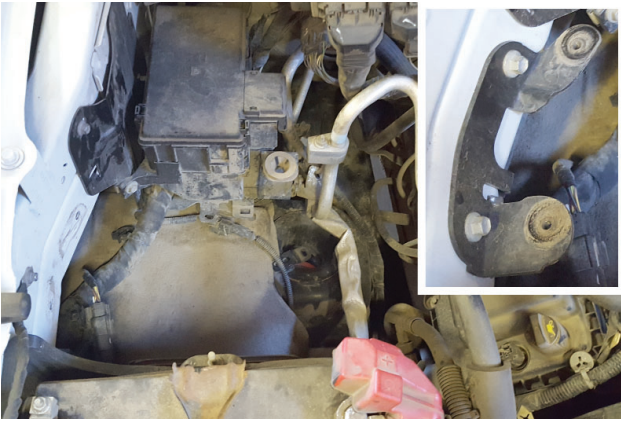

7. Remove bolts (x2) and mounting bracket for airbox.

ASSEMBLE & INSTALL COLD AIR INTAKE:

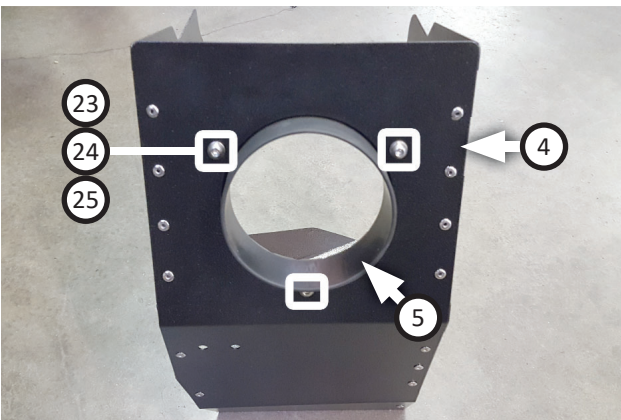

8. Install air filter adapter (5) into airbox (4) using (x3 ea.) screws (23), lock washers (24) and flat washers (25).

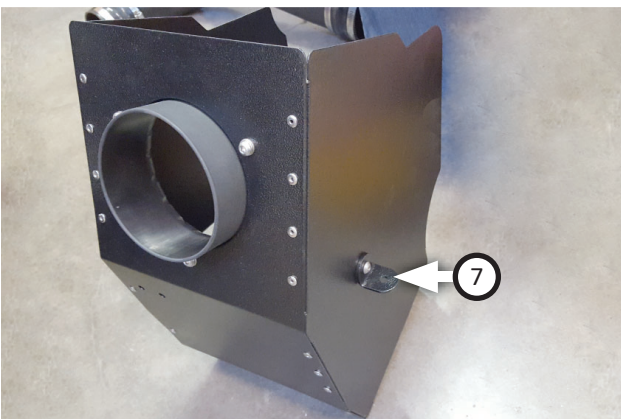

9. Install bracket 2 (7) onto airbox oriented as shown using screw (26), flat washer (27), lock washer (28) and nut (29).

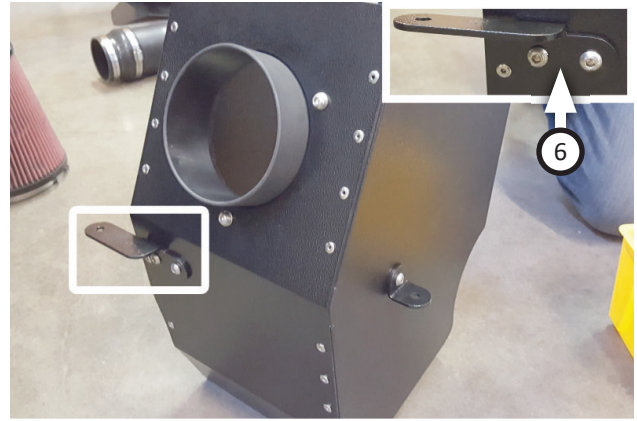

10. Install bracket 1 (6) onto airbox oriented as shown using (x2 ea.) screws (26), flat washers (27), lock washers (28) and nuts (29).

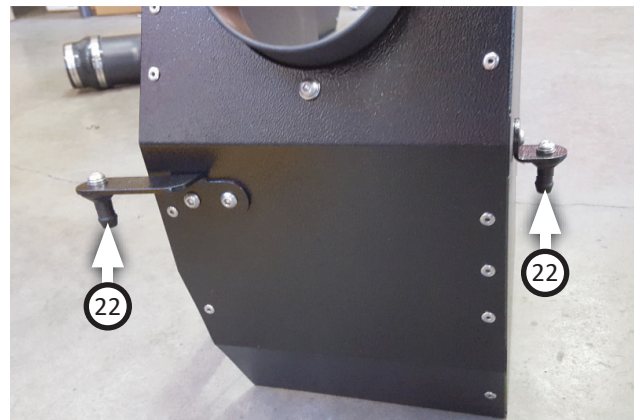

11. Install barbed pins (x2) (22) onto brackets using (x2 ea.) screws (23), lock washers (24) and flat washers (25).

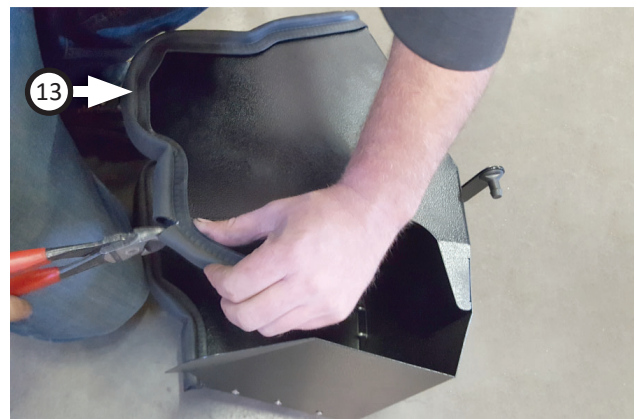

NOTE: Do not wrap bottom edge of airbox, or it will not install in your vehicle properly.

12. Wrap heat shield gasket (13) around edges of airbox, making sure it fits tightly. Once finished, keep remaining gasket for later use.

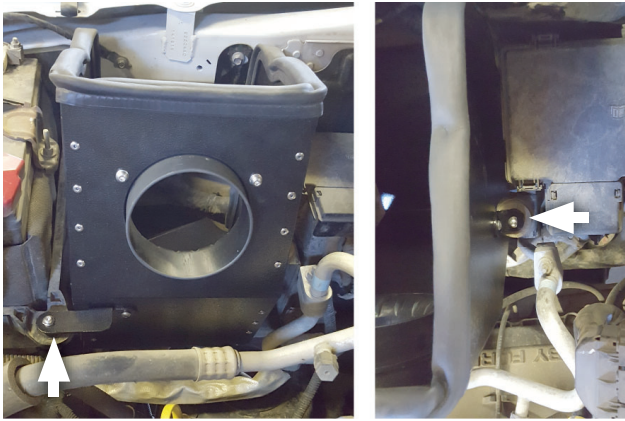

13. Place airbox into engine compartment, inserting barbed pins (x2) into factory grommets.

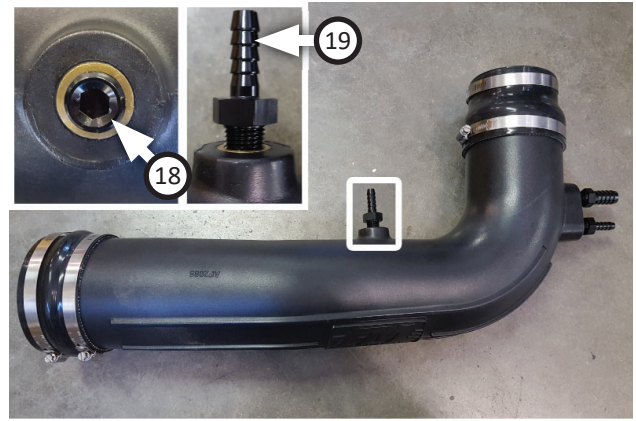

NOTE: For vehicles without vacuum line (step 4), complete step using **NPT plug (18)** in place of fitting.

16. Apply PTFE tape to **male fitting (19)** then thread it into intake tube mount.

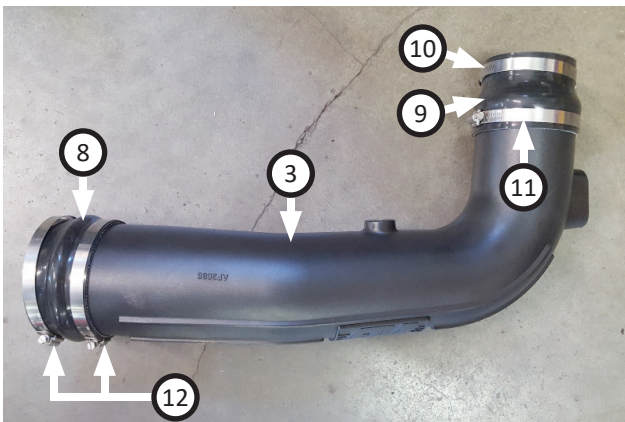

14. Fit (x4) **screw clamps (10-12)**, **hump (8)** and **straight (9) couplers** onto **molded intake tube (3)** as indicated by picture. Tighten clamps just enough to allow for later adjustment.



17. Place intake assembly into engine compartment between airbox and throttle body. Press couplers against stops then center tube. Tighten screw clamps completely.

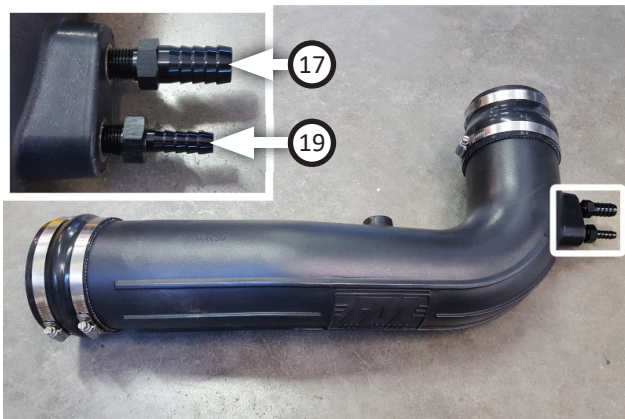

15. Apply PTFE tape to **male fittings (17), (19)** then thread them into intake tube mount.

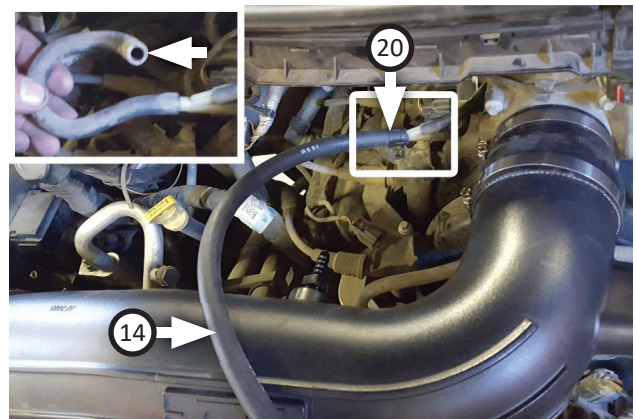

18. If applicable, remove factory hose from engine compartment then install **hose (14)**, securing connection using **pinch clamp (20)**.

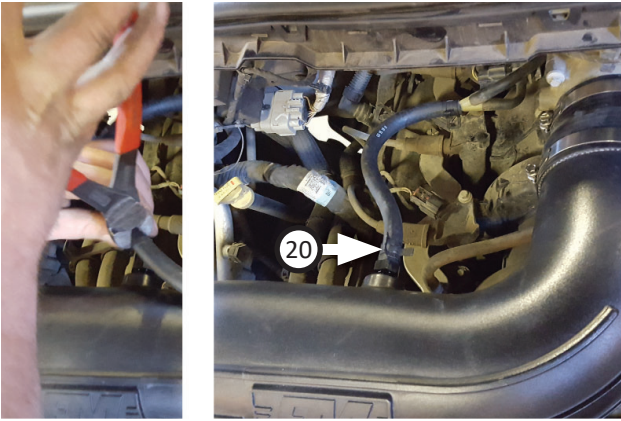

19. Cut hose to length so it reaches fitting connect and secure it using **pinch clamp (20)**.

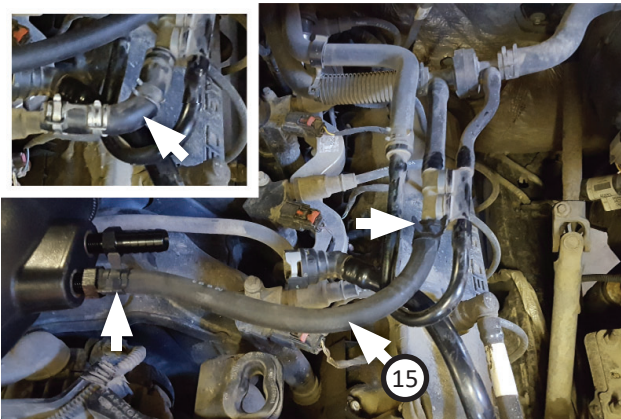

20. Remove factory hose shown, then replace it using **hose (15)**. Connect its other end to fitting secure it using (x2) **pinch clamps (20)**.

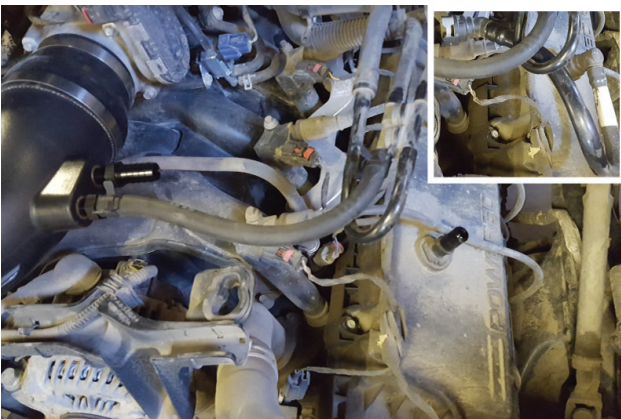

21. Disconnect PCV from valve cover and remove it from vehicle.

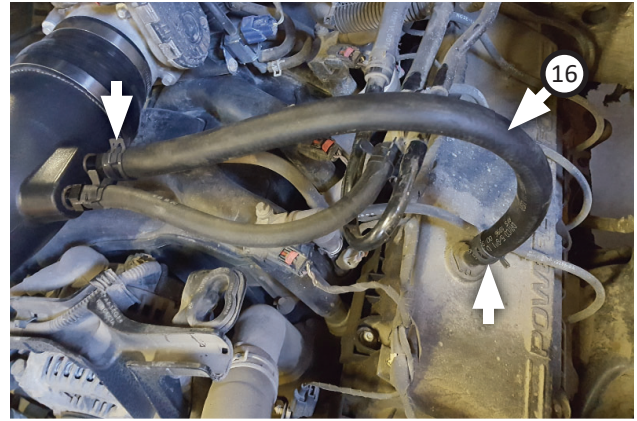

22. Connect **hose (16)** to valve cover, then route its other end over to fitting. Secure connections using (x2) **pinch clamps (21)**.

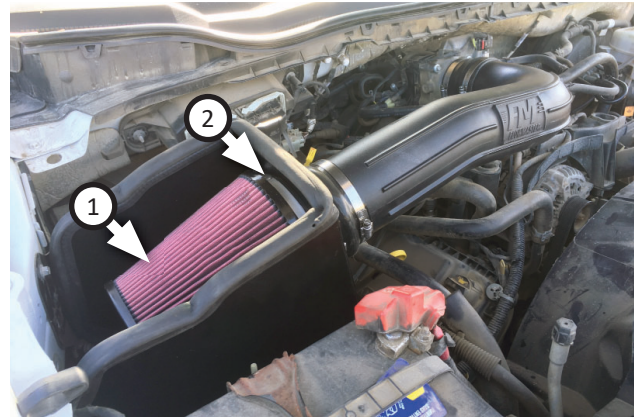

23. Set **air filter (1)** over air filter adapter in airbox. Secure them together by tightening **screw clamp (2)** at its base. Then inspect all connections, making sure your system fits and is properly sealed.



Congratulations, the installation of your Flowmaster Performance Intake system is now complete!

